

Hitch

Adventure is a Hitch away.



CRUISER RV

Great American Trailers.



Hitch:

A new way to enjoy the outdoors.

Built to handle extreme terrain but towable with lightweight vehicles, Hitch is the newest product line to be introduced by Cruiser RV. Hitch is a fun, industrial built ultra-lite travel trailer equipped with unique features for today's adventurous camper. With an all-aluminum superstructure, Azdel composite walls, and plywood floors it holds true to Cruiser RV's mission of building Great American Trailers. The Hitch lineup consists of 4 extremely functional floor plans that are 7' wide, 17'-21' long, and weighing 3,500-4,000lbs. Our standard fiberglass roof, 15" tires, and single torsion axles are built for the season, and any terrain you want to explore. And the best thing about Hitch, is there is no need to plug in! Our standard 1200W inverter with 110W roof mounted solar panel allows you to go where you want, when you want and enjoy the high-end amenities that come standard. With so many features and so much flexibility, adventure is just a Hitch away.



HITCH

Only weighs 3500lbs-4000lbs



Strong Foundation

- 15" All-Terrain Tires
- Torsion Axle
- Power Tongue Jack
- Welded Bumper
- 4-Corner Jacks



Ultra-lite Construction

- Fully Walkable Roof
- 6-Sided Aluminum
- Azdel Composite Walls
- 5/8" Tongue & Groove plywood flooring



Solar Power

- 1200W Inverter
- 110W Solar Panel
- Solar Monitor
- 110W Outlet Control



Camping Conveniences

- Wifi HD Antenna
- 4G LTE Prep
- 12V TV w/ DVD
- Battery Disconnect
- Largest pass-through storage in its class
- 47 gallon fresh water tank with heat pads



Cruiser Care

- 100% pre-delivery testing
- State-of-the-art production & warehouse facilities
- 1-year limited factory warranty
- 3-year limited structural warranty
- Multi-year supplier warranties



Step inside Hitch to see our top features

1. Sleek, simple, European styled cabinetry with two-toned color scheme
2. Solid surface kitchen countertops and recessed gas cooktop
3. Seamless marine grade flooring for easy cleaning
4. Standard 60"x80" Queen sized bed
5. Indoor/Outdoor dinette



For more information and full technical specifications, visit our website at cruiserrv.com

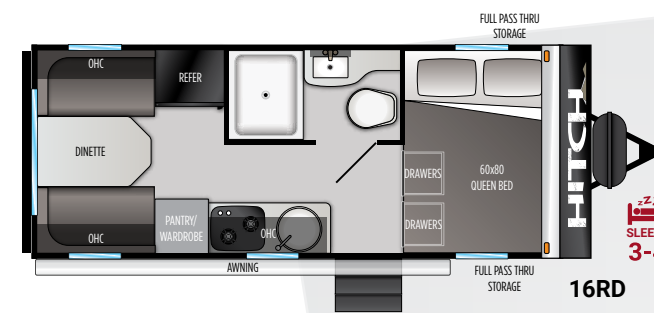

Length 21' 1" Dry 3,586 lbs. Hitch 384 lbs. Height 10' 2"

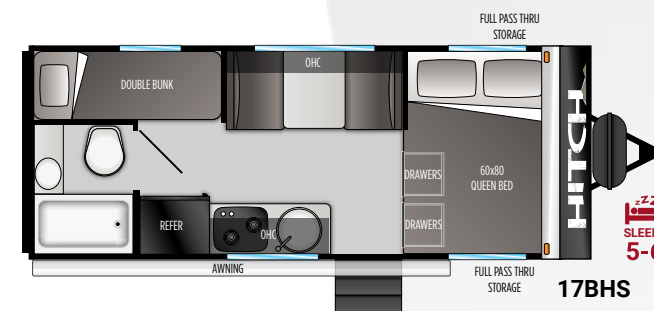

Length 21' 1" Dry TBD Hitch TBD Height TBD

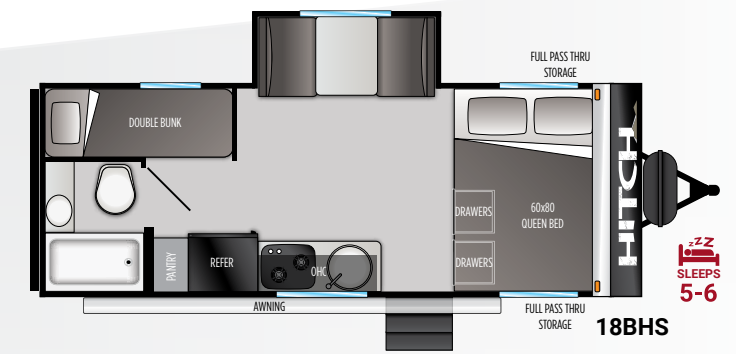

Length TBD Dry TBD Hitch TBD Height TBD

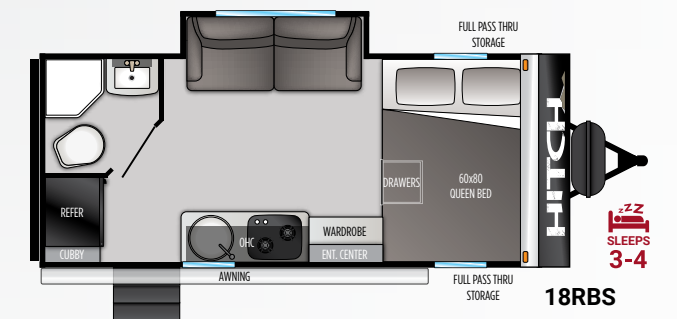

Length TBD Dry TBD Hitch TBD Height TBD

Hitch comes loaded with additional features like:

- City Water Hook-up
- Black Tank Flush
- Spray Hose and Hook-up
- Backlit Hybrid Entry Step
- 26" Entry Door w/ Oversized Grab Handle
- Powder Coated Steel Fenders and Table
- Power Awning w/ LED Light
- Exterior Speakers
- Matching Spare Tire
- Rear Mounted Ladder
- Dual 20lb LP Tanks
- 2 Pet Friendly Leash D Rings



A Great American Trailer Company.

Since 1988, Cruiser RV has built lightweight, high-quality trailers for people who love the great outdoors. Here at Cruiser, we take the time to construct solid, hard-working trailers and toy haulers that *last*. These are the towables that help you feel safe, comfortable and free to enjoy the great American RV lifestyle. Ultra lightweight, easy to tow, and loaded with the kind of luxury and high-end features our customers expect, Cruiser RVs are easily the best value on the road. No matter what new adventure lies ahead, you'll find freedom at every turn with a Cruiser RV.

Your Local Cruiser RV Dealer:



WE'RE BEHIND YOU ALL THE WAY.

With state-of-the-art factory service facilities and more than 400 dealers across the U.S. and Canada, you're never far from an authorized Cruiser RV dealer.



CRUISER RV
Great American Trailers.

CRUISERRV.com

7805 North SR 9 • Howe, IN 46746 • 866-277-5630



MADE IN THE U.S.A.

Product information is as accurate as possible as of the date of publication of this brochure. Due to Cruiser's commitment to continuous product improvement, floor-plans, materials, components, features, measurements, specifications, options, etc. are subject to change at any time without notice or obligation. In certain conditions some additional equipment may be needed. Photos may show optional equipment or props used for photography purposes only. Cruiser has listed the approximate base weight of the trailer without the optional equipment included. Optional equipment will impact the weight of the trailer. Please locate the weight sticker attached to the trailer you are considering for the most accurate trailer weight. Tow Vehicle Caution: Owners of Cruiser recreational vehicles are solely responsible for the selection and proper use of tow vehicles. All customers should consult with the motor vehicle manufacturer or their dealer concerning the purchase and use of suitable tow vehicles for Cruiser products. Cruiser disclaims any liability or damages suffered as a result of the selection, operation, use or misuse of a tow vehicle. Cruiser's limited warranty does not cover damage to the recreational vehicle or the tow vehicle as a result of the selection of the tow vehicle. Overall length for a Fifth Wheels is defined as the body length of the trailer excluding hitch meaning bumper to cap. The overall length for a Travel Trailer is defined as the body length of the trailer including hitch, meaning bumper to hitch/pin) It does not include rear ladder or spare tire. Optional pin boxes will affect overall length.