



# ***SURVEYOR***

---

## ***FOREST RIVER***

We invite you to  
take the road  
less traveled...  
and make it  
all the difference.



**SUB 4S**

**LEGENDS**

**GRANDS**



**Surveyor Production Team:** (Left to Right) Dale G., Service/Production Floater since 2001, Wayne "Junior" T., Group Plant Manager -3 Plants, Brian S., Plant Manager, 17 years+

# SURVEYOR

## FIELD TESTED SINCE 2001

“DO YEARS IN BUSINESS AND EXPERIENCE BUILDING RV’S AT THE SAME FACTORY MATTER WHEN CHOOSING WHICH TRAVEL TRAILER TO PURCHASE ... WE THINK IT SHOULD!”

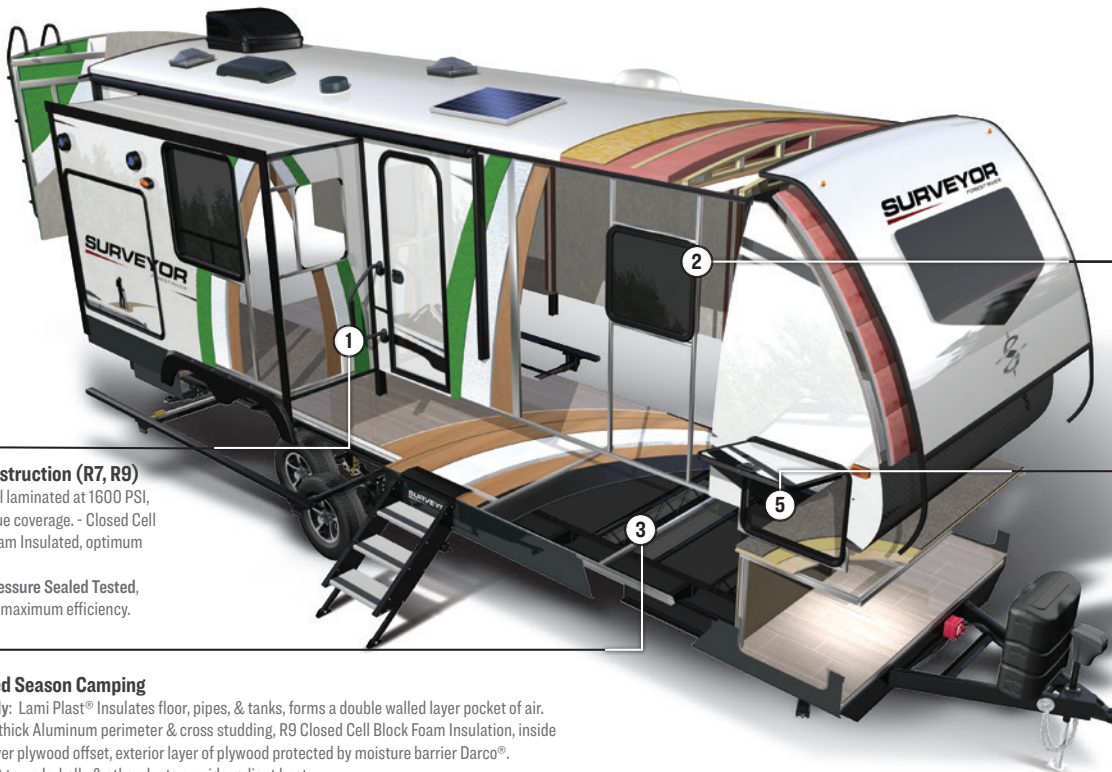

### Aluminum Framing All Openings

Windows; No caulking required, saves time and up to \$100s annually! Best structural integrity in its class.

### Best In Industry Pass-Through Storage

Oversized, clean finish: Slam Latch Baggage Handle, 3/4" Stab Jack Drill Bit, Motion Sensor Light, and Aluminum Bed base!

### Wall Construction (R7, R9)

- Pinch roll laminated at 1600 PSI, 100% glue coverage. - Closed Cell Block Foam Insulated, optimum comfort.
- Air-Pressure Sealed Tested, ensures maximum efficiency.

### Extended Season Camping

- Underbelly: Lami Plast® Insulates floor, pipes, & tanks, forms a double walled layer pocket of air.
- Floor: 2" thick Aluminum perimeter & cross studding, R9 Closed Cell Block Foam Insulation, inside double layer plywood offset, exterior layer of plywood protected by moisture barrier Darco®.
- Heat Duct to underbelly & other ducts provide radiant heat.

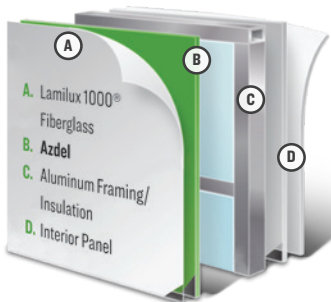

### Azdel Onboard

Composite Panels, Patented Blend of Polypropylene and Fiberglass, replaces "wood" backing. Surveyor uses on Sides, Rear, Slide Room, and Front Walls (N/A Front of Grands, Fiberglass Cap)

- Protects against delamination - repels water; no rot, mold, or warpage
- Unaffected by humidity or temperature changes
- 2x insulation value - Blankets like a "Radiant Foil"
- 1/2 the weight of wood - keeps fuel costs down
- Longer life and better resale value
- Quieter RV - absorbs sound waves

### PVC Membrane - Fully Walkable Roof

16" On-Center trusses featuring 3/8" decking, R14 Residential Blanket Insulation, finished with Best in Class PVC Roof Membrane.

- No treatments required — Ever! Save time every 6-12 months & up to \$100s annually.
- 15 Year Warranty, 100% coverage.
- 2x the puncture strength & 20% more tear resistance
- Will not chalk, streak, or spot.
- Extraordinary reflectivity keeping your trailer cooler





## SOLAR PANEL ON EVERY SURVEYOR!



**Go Power!**

**SOLARONBOARD.COM**  
1.866.247.6527

## SERVICE MANAGER, REPEAT BUYER

I have been the Parts/Service manager at a Forest River dealer for 16 years and counting. When I wanted my first RV I had the choice to order any brand and model that I wanted, I chose Surveyor. Now after my 2nd new Surveyor I am still highly pleased. The Surveyor brand RV's are well thought out and I love the quality of work that goes into them inside and out. I will always be a dedicated Surveyor customer. I know the RV industry well from my years in service and I highly recommend the Surveyor brand above all others.

**Rick Winfrey**  
Corpus Christi, TX, 2020

**“DO NOT GO WHERE THE PATH MAY LEAD,  
GO INSTEAD WHERE THERE IS NO PATH,  
AND LEAVE A TRAIL”**

— RALPH WALDO EMERSON



Near to far: Brenna F., Quality/Final Finish Leader, 16years. Shae S. M., PDI/Quality Leader, 8 years.

## EVERY SURVEYOR PDI FINAL INSPECTION STATION

“Giving you our Very Best so you can Camp in Confidence!”

### OUTSIDE KITCHEN EVERY MODEL! (SUB 4s: GRIDDLE, PREP SHELF, & SPRAY PORT)



### 10 CU FT 12V REFRIGERATOR (WEST COAST 8 CU FT G/E)



### FRONT BAGGAGE DOOR

SLAM LATCH, MOTION  
SENSOR, STAB JACK BIT,  
ALUMINUM FRAMING

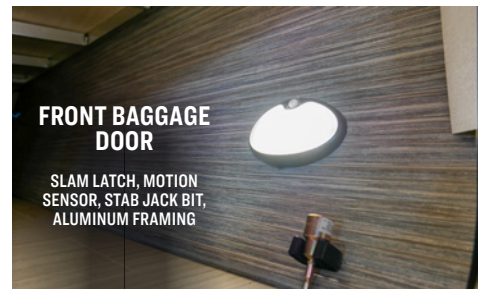

### CLEANEST FRONT END

PT JACK, BATTERY DISCONNECT, AUTO LOOM CABLES,  
7-PLUG HOLDER, & SAFETY CHAIN/PET LEASH HOLDER

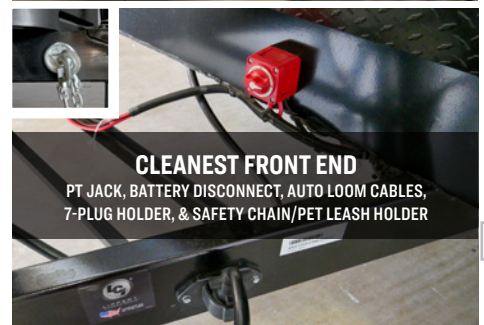



BUNKS!



SUB 4S OUTSIDE KITCHEN



19BHLE



BEST SMALL TRAILER BATHROOMS IN INDUSTRY!



19RBLE

SURVEYOR LEGEND

SUB-4,000 LB.

Sub-4s start below 4,000 lbs and are packed with fun! Designed for those wanting their own "Bungalow" on wheels; shorter, lighter, living an active on the go lifestyle, without having to compromise "Comforts".

"I WENT INTO THE FOREST TO LOSE MY MIND, AND FIND MY SOUL"

— JOHN MUIR

- 78" INTERIOR HEADROOM
- 15K
- SOLAR PANEL (ROOF MOUNTED)
- SLOW ROLL CLOSE SHOWER DOORS
- PORCELAIN TOILET
- 100% LED LIGHTING EXTERIOR & INTERIOR
- HIGH OUTPUT W/H
- USB PORTS

19BHLE



19RBLE

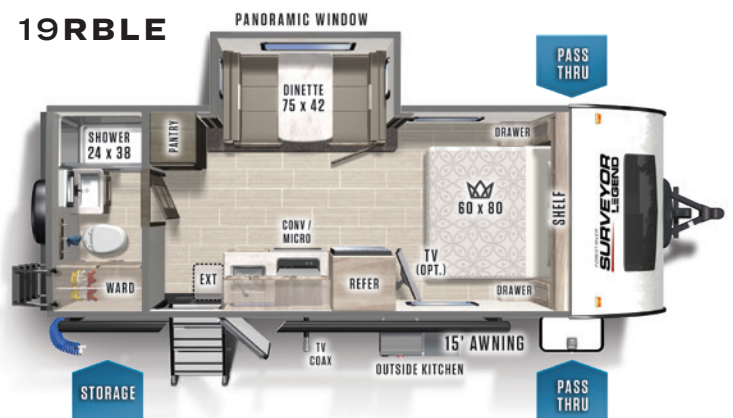

	UVW	HITCH	C.C.C.	LENGTH *	HEIGHT **	CAPACITY (GAL.)
19BHLE	3814	405	991	23' 4"	10' 3"	30 30 30
19RBLE	3749	345	996	23' 4"	10' 3"	30 30 30

FRESH GRAY BLACK

\*LENGTH FROM COUPLER TO BUMPER // \*\*HEIGHT INCLUDES TOP OF A/C





203RKLE



240BHLE



Easy enough to do single-handedly!



No Mattress-Open Storage!



203RKLE



240BHLE

SURVEYOR LEGEND  
**MURPHY BEDS**

- 82" HEAD ROOM
- 15K BATTERY
- SOLAR PANEL (ROOF MOUNTED)
- SLOW ROLL CLOSE SHOWER DOORS
- PORCELAIN TOILET
- 100% LED LIGHTING EXTERIOR & INTERIOR
- HIGH OUTPUT W/H
- USB

Legend Murphy Beds are better designed and the smartest use of space in order to tow a shorter trailer that has both a dinette & sofa. They come equipped with the super easy to use "Catch & Latch" system for operating our **True Queen Size Bed, 60" x 80"** (others use smaller 60" x 74" beds)!

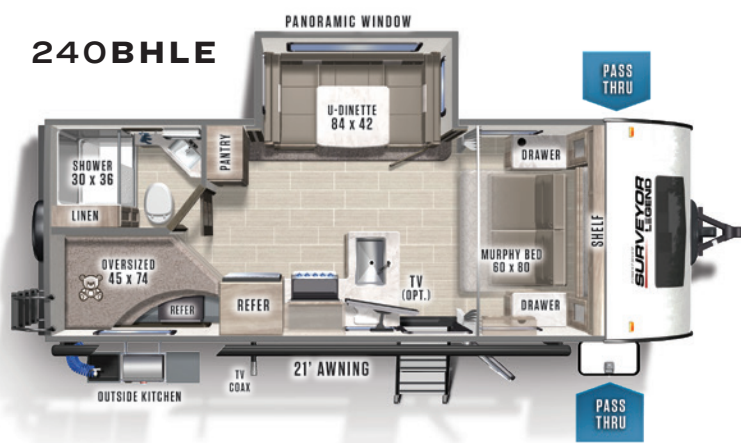
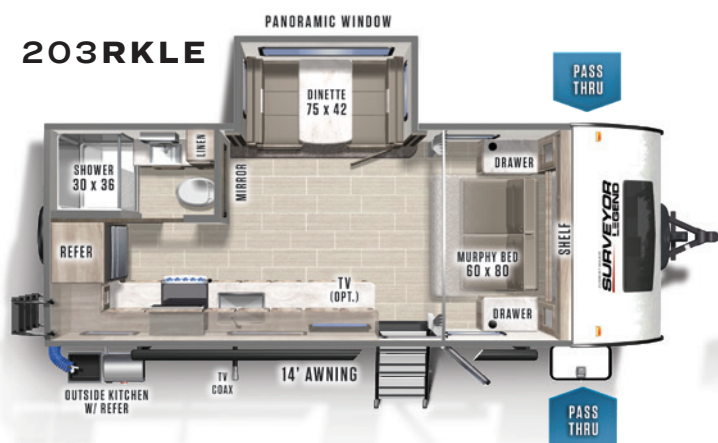

	UVW	HITCH	C.C.C.	LENGTH *	HEIGHT **	CAPACITY (GAL.)		
203RKLE	5030	577	2547	24' 4"	11' 3"	40	40	30
240BHLE	5137	517	2380	25' 11"	11' 3"	40	30	30

\*LENGTH FROM HITCH TO REAR BUMPER // \*\*HEIGHT INCLUDES TOP OF A/C

FRESH GRAY BLACK

Scan QR or visit [forestriverinc.com/Surveyor](http://forestriverinc.com/Surveyor)





LEGEND BEDROOMS



LEGEND BATHROOMS



LEGEND KITCHENS



202RBLE



296QBLE



252RBLE



320BHLE

# SURVEYOR LEGENDS

“WE DON'T STOP  
PLAYING BECAUSE  
WE GROW OLD, WE  
GROW OLD BECAUSE  
WE STOP PLAYING”

— GEORGE BERNARD SHAW



320BHLE

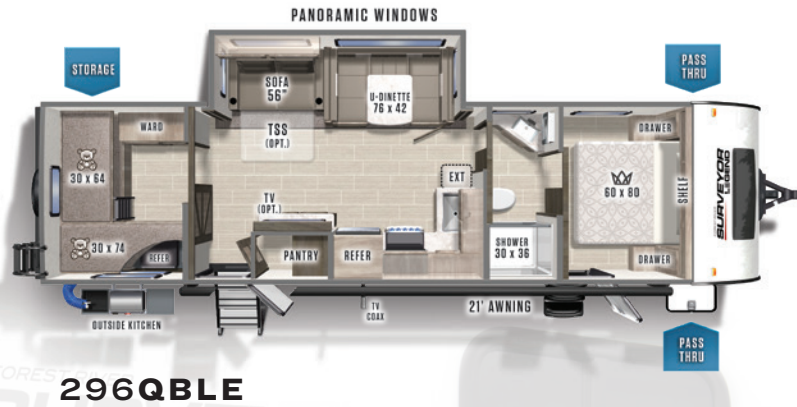
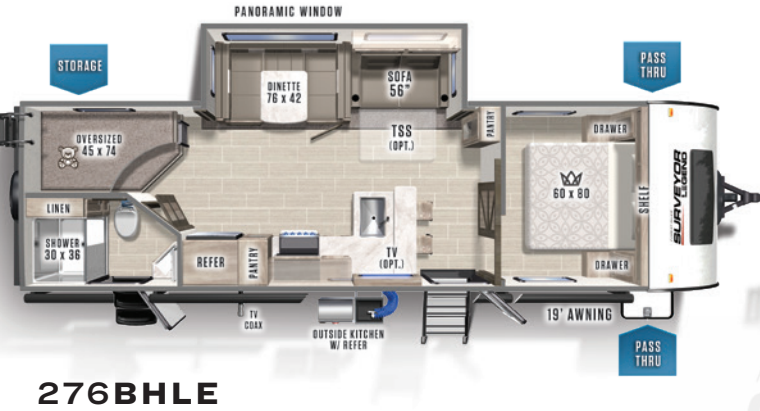
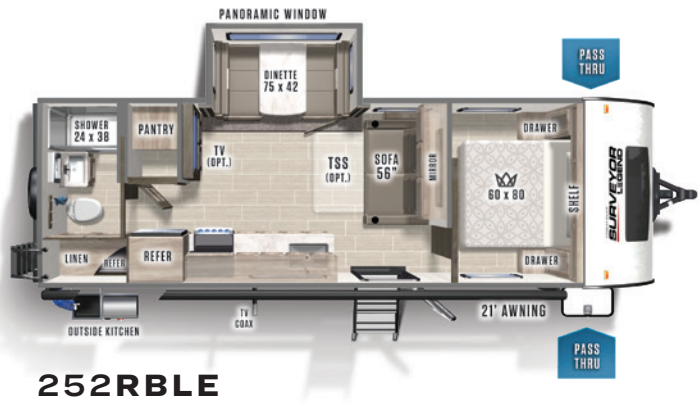
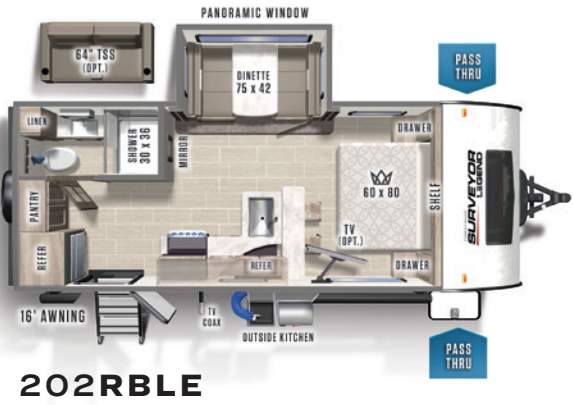

FORESTRIVER  
**SURVEYOR  
LEGEND**



**“I don’t just sell them, I camp in them.”**

**Reid G.,**  
Regional Sales Manager,  
Serving our customers & RV dealerships since 2003.

- 82" HEAD ROOM
- 15K
- SOLAR PANEL (ROOF MOUNTED)
- SLOW ROLL CLOSE SHOWER DOORS
- PORCELAIN TOILET
- 100% LED LIGHTING EXTERIOR & INTERIOR
- HIGH OUTPUT W/H
- USB PORTS

	UVW	HITCH	C.C.C.	LENGTH *	HEIGHT **	CAPACITY (GAL.)		
<b>202RBLE</b>	4931	497	2566	24' 4"	11' 2"	40	40	30
<b>252RBLE</b>	5313	590	2277	29' 4"	11' 2"	40	40	30
<b>276BHLE</b>	6358	650	1292	32' 6"	11' 3"	40	40	30
<b>296QBLE</b>	6806	804	2796	34' 11"	11' 3"	40	40	30
<b>320BHLE</b>	7764	847	1883	37' 0"	11' 3"	40	80	70

\*LENGTH FROM COUPLER TO BUMPER // \*\*HEIGHT INCLUDES TOP OF A/C

FRESH GRAY BLACK

Scan QR or visit [forestriverinc.com/Surveyor](http://forestriverinc.com/Surveyor)





# GRAND SURVEYOR

## TSS - "EXCLUSIVE" TO SURVEYOR



1 - THEATER SEAT



2 - SOFA

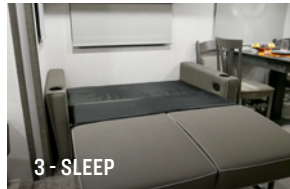

3 - SLEEP

... to make old New Again!, the renaming goes back to our Roots almost 20 years. What can be more than "Grand", we think this is Glamping at its best, welcome to your 5-Star Resort On Wheels!

**"WE TRAVEL NOT TO ESCAPE LIFE, BUT FOR LIFE NOT TO ESCAPE US."**

— ANONYMOUS



GRAND ENTERTAINMENT



GRAND BEDROOMS



GRAND KITCHENS & DINETTES



GRAND BATHROOMS



# SURVEYOR EXTRAS!



**RACK**  
(GRAND STD., LEGEND OPT.)



**HEAT DUCTS**  
(AND ONE TO THE UNDERBELLY)



**MORRYDE®**  
ALUMINUM PLATFORM STEPS



**PET-FRIENDLY,**  
ADVENTURE APPROVED



**BATHROOM TRASH CAN**

**LAUNDRY BAG**



**FRICTION HINGE ENTRY DOOR(S)**

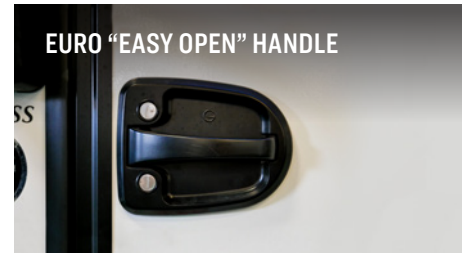

**EURO "EASY OPEN" HANDLE**

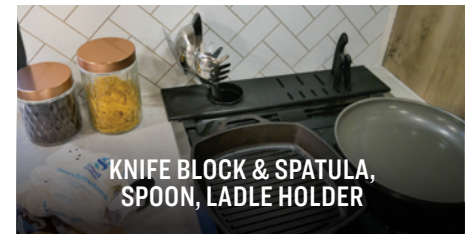

**KNIFE BLOCK & SPATULA,**  
SPOON, LADLE HOLDER



**267RBSS**



**272FLS**



**82"**  
HEAD ROOM



**SOLAR PANEL**  
(ROOF MOUNTED)



**HIGH OUTPUT**  
W/H



**PORCELAIN**  
TOILET



**15K**



**100% LED**  
LIGHTING  
EXTERIOR & INTERIOR



**USB**  
PORTS



**GLASS**  
SHOWER  
DOORS



**ROLLER**  
SHADES

UVW      HITCH      C.C.C.      LENGTH \*      HEIGHT \*\*      CAPACITY (GAL.)

<b>267RBSS</b>	6063	615	1652	30' 7"	11' 3"	<b>40 60 30</b>
<b>272FLS</b>	6118	865	1747	31' 8"	11' 3"	<b>40 40 30</b>

**FRESH GRAY BLACK**

\*LENGTH FROM COUPLER TO BUMPER // \*\*HEIGHT INCLUDES TOP OF A/C





# WEST COAST

At Surveyor, Customer Satisfaction is #1 and we do a couple of features standard specifically requested by RV customers and dealers from Colorado, Westward. We're glad we listened.



ARCTIC PACKAGE



8 CU. FT. G/E



## "ABOVE THE BAR" IN CUSTOMER SERVICE & WARRANTY

Forest River 12 Months Bumper-To-Bumper  
24/7 Roadside Assistance Saferide Motor Club (1st year)

- AXLES**  
(6 YEARS)
- EXTERIOR GRAPHICS**  
(5 YEARS)
- LAMILUX® FIBERGLASS**  
(2 YEARS)
- LINOLEUM**  
(7 YEARS)

- PVC ROOF**  
(15 YEARS)
- SOLAR PANEL**  
(25 YEARS)
- TIRES**  
(12 MONTH "NO EXCUSES", 2 YEAR ROADSIDE ASSISTANCE, 5 YEAR DEFECTS)



## IT'S A FAMILY AFFAIR! REPEAT BUYERS

I work in the RV Business and live in the heart of it all. It was time for us to get a camper, so in 2019 my wife and I purchased a Surveyor. My in-laws have owned a Surveyor bunkhouse since 2014, and with the kids grown, they wanted a couple's trailer. The timing was right so we bought their Surveyor (now our 2nd), and they again chose to buy a New Surveyor 2020 (their 2nd one). Then we gave our Surveyor to my dad! We are a sight to see when we camp together! All of us love our Surveyor's and would happily purchase another.

**The Heck Families**  
Elkhart, IN. 2019



You may be camping for a night or taking the trip of a lifetime, Surveyor King Bed Models have the storage space and features to ensure everlasting memories... Carpe Diem!

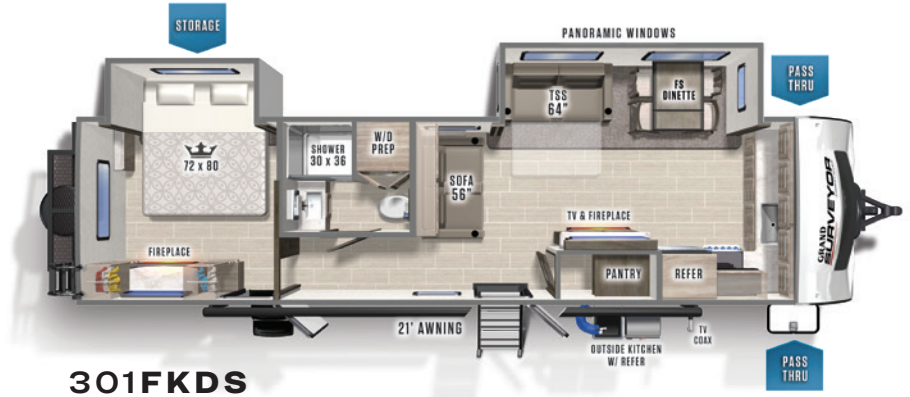
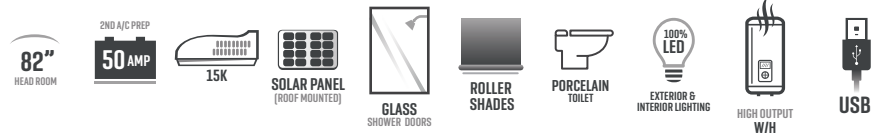

	UVW	HITCH	C.C.C.	LENGTH *	HEIGHT **	CAPACITY (GAL.)
301FKDS	7603	995	2195	36' 7"	11' 5"	40 60 30
302RLOK	8343	875	1332	36' 7"	11' 5"	40 75 35

FRESH GRAY BLACK

\*LENGTH FROM HITCH TO REAR BUMPER // \*\*HEIGHT INCLUDES TOP OF A/C

Scan QR or visit [forestriverinc.com/Surveyor](http://forestriverinc.com/Surveyor)



**PEACE OF MIND - YOU'RE NEVER ALONE**



**24/7 EMERGENCY  
ROADSIDE ASSISTANCE  
WITH VEHICLE PURCHASE\***

TOWING  
JUMP-STARTS  
TIRE CHANGES  
FLUID DELIVERY  
LOCKOUT  
SERVICE

WINCH-OUT  
MOBILE MECHANIC  
TECHNICAL  
SUPPORT  
DEALER LOCATOR  
SERVICES



\*VALID FOR 1 YEAR FROM DATE OF PURCHASE



Left to right: (entire department not shown):  
**Susan T.**, Warranty/Parts/Service Manager,  
taking care of everyone's needs since 2006.  
**Amanda H.**, Senior Parts Administrator,  
shipping the right parts fast Worldwide.

**WARRANTY, PARTS,  
& SERVICE.  
IN-HOUSE TO BETTER SERVE.**

**CUSTOMER SATISFACTION**



**www.Forest River Buy Local.com**  
**WWW.FORESTRIVERINC.COM/SURVEYOR**

Whether at an Ocean Front campsite or **OTG (OFF THE GRID)**, RV'ing is not just a thing you do, it's a lifestyle! At **SURVEYOR SERVICE**, we get it.

**FREE MEMBERSHIP**  
to Forest River Owners' Group  
[www.forestriverfrog.com](http://www.forestriverfrog.com)

**FOREST RIVER OWNER "DIGITAL KIT" APP**  
Now you can have your Owner's Manual with you wherever you are. Download our FREE App from the App Store or Google Play and you'll have the information right at your fingertips.



**Surveyor Division,**  
Forest River, Inc.  
2405 Century Dr.,  
Goshen, IN 46528  
(574) 642.3119



**Learn More**  
Scan this barcode using a QR Reader on your smart phone to learn more about Forest River.



A Berkshire Hathaway company.

**QUALITY PDI TESTING EVERY DAY!**



**PRE-DELIVERY INSPECTION FACILITY**

20,000 square feet of quality assurance. The bare essentials for a premium product. This state-of-the-art facility gives immediate daily feedback to production for quality assurance in every unit built.

**GVWR (Gross Vehicle Weight Rating)** - is the maximum permissible weight of the unit when fully loaded. It includes all weights, inclusive of all fluids, cargo, optional equipment and accessories. For safety and product performance do NOT exceed the GVWR.

fresh potable water, additional optional equipment or dealer installed accessories.

\*Estimated average based on standard build optional equipment.

**GAWR (Gross Axle Weight Rating)** - is the maximum permissible weight, including cargo, fluids, optional equipment and accessories that can be safely supported by a combination of all axles.

**CCC (Cargo Carrying Capacity)\*\*** - is the amount of weight available for fresh potable water, cargo, additional optional equipment and accessories. CCC is equal to GVWR minus UVW. Available CCC should accommodate fresh potable water (8.3 lbs per gallon). Before filling the fresh water tank, empty the black and gray tanks to provide for more cargo capacity.

**UVW (Unloaded Vehicle Weight)\*** - is the typical weight of the unit as manufactured at the factory. It includes all weight at the unit's axle(s) and tongue or pin and LP Gas. The UVW does not include cargo,

\*\* Estimated average based on standard build optional equipment

Each Forest River RV is weighed at the manufacturing facility prior to shipping. A label identifying the unloaded vehicle weight of the actual unit and the cargo carrying capacity is applied to every Forest River RV prior to leaving our facilities.

The load capacity of your unit is designated by weight, not by volume, so you cannot necessarily use all available space when loading your unit.

All information contained in this brochure is believed to be accurate at the time of publication. However, during the model year, it may be necessary to make revisions and Forest River, Inc., reserves the right to make all such changes without notice, including prices, colors, materials, equipment and specifications as well as the addition of new models and the discontinuance of models shown in this brochure. Therefore, please consult with your Forest River, Inc., dealer and confirm the existence of any materials, design or specifications that are material to your purchase decision. Litho. U.S.A. FOR 1784 P/W: 2020.11.24

**YOUR SURVEYOR DEALER**